



ACCESSORY SETUP INSTRUCTION

WINDSHIELD ASSEMBLY -- PN 9AW#-806000-2100

VALID FOR: MY2020 CFORCE 800ATV

BEFORE YOU BEGIN: Read and understand the instructions before starting any work. Make sure that all parts are ready and that you have all the tools required for assembly.

NOTE: CFMOTO shall not be liable for any damage caused by incorrect assembly. CFMOTO recommends that all original accessories be assembled by an authorized CFMOTO dealer.

Before assembly, park the vehicle on a flat surface, put the transmission gear into Park (P) and turn off the key switch.

Zhejiang CFMOTO Power Co., Ltd. All rights reserved. Reproduction of this document, even in part, as well as copying of all kinds, is permitted only with the express written permission of the copyright owner.

MEANING OF SYMBOLS



- Indicates information with more details or tips.



- Indicates information of warning or danger.

PARTS LIST:

| ITEM | PART NAME | PART NUMBER | QTY. | REMARK |
|------|--------------------------|-------------------|------|--------|
| 1 | WINDSHIELD | 6NTA-201401-80000 | 1 | |
| 2 | TANK PANEL RUBBER DAMPER | A000-040302 | 4 | |
| 3 | LEFT WINDSHIELD BRACKET | 9AW#-806101-2100 | 1 | |
| 4 | RIGHT WINDSHIELD BRACKET | 9AW#-806102-2100 | 1 | |
| 5 | LEFT REINFORCING PLATE | 9AW#-806103-2100 | 1 | |
| 6 | RIGHT REINFORCING PLATE | 9AW#-806104-2100 | 1 | |
| 7 | CABLE PROTECTOR | 9AW#-806105-2100 | 2 | |
| 8 | INNER HEX SCREW M6X16 | A010-120003 | 6 | |
| 9 | INNER HEX SCREW M6X20 | 30102-080020870 | 4 | |
| 10 | NUT | 30206-060570 | 10 | |
| 11 | WASHER 6X20X1.5 | 30309-060870 | 4 | |
| 12 | WASHER | 30303-060070 | 6 | |
| 13 | WINDSHIELD ASSEMBLY | 9AW#-806000-2100 | 1 | |

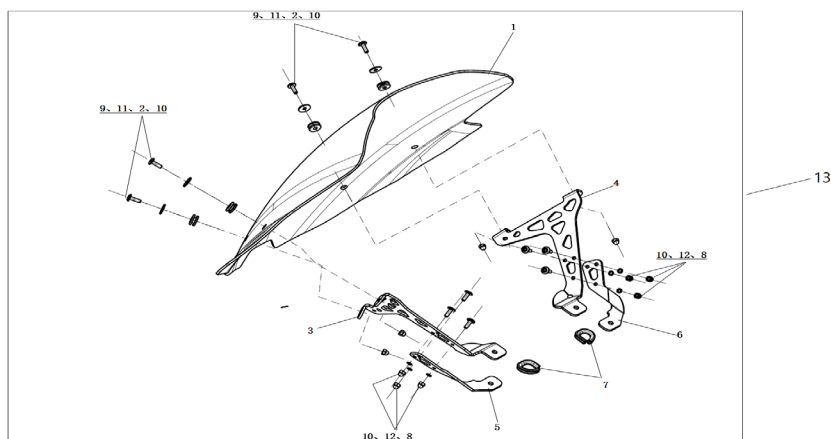

TOOL LIST:

| ITEM | DESCRIPTION | QTY. | REMARK |
|------|--------------------------|------|-------------------|
| 1 | TORQUE WRENCH | 1 | Recommended Tools |
| 2 | OPEN-ENDED WRENCH 8-10mm | 1 | |
| 3 | 13mm SOCKET | 1 | |
| 4 | 4mm ALLEN WRENCH | 1 | |
| 5 | MARKER | 1 | |
| 6 | PROTECTIVE GLOVES | 1 | |

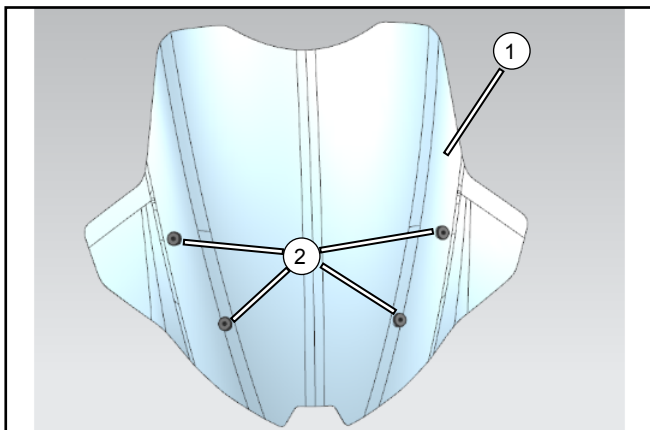

// Install the rubber dampers (2) into the windshield (1) mounting holes.



// Remove the handlebar upper guard (A).



// Remove the handlebar clamp bolts (A).

i Mark the angle of the handlebar in the clamps with a marker before removing the bolts to facilitate control of the installation angle during subsequent reassembly.

| | | | |
|------|-------|-----------------|---|
| BOLT | M8X60 | 30006-080060810 | / |
|------|-------|-----------------|---|

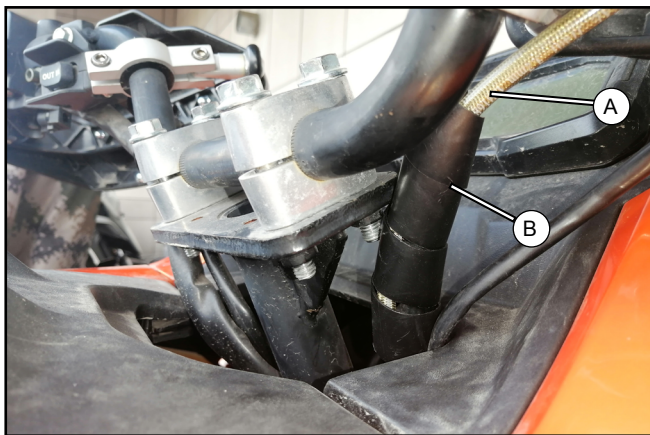

// Wrap the brake fluid hose (A) with the cable protector(B).

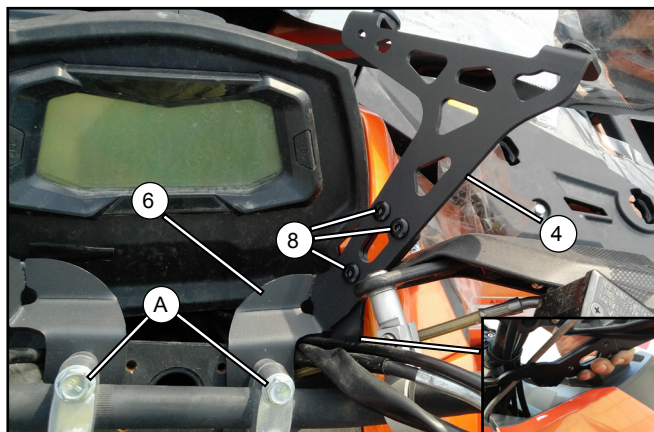

- // Install the windshield brackets (4) under the handlebar clamps . Reinstall the clamp bolts (A) and finger-tighten.
- // Install the reinforcing plate (6) under the windshield brackets with inner hex screws (8).Torque the fasteners to specification.

i Wire harness and brake fluid hose pass through the reserved hole in the middle of bracket.

| | | | |
|-----------------|-------|-----------------|----------|
| BOLT | M8 | 30006-080060810 | 22-30N.m |
| INNER HEX SCREW | M6X16 | A010-120003 | 8-12N.m |

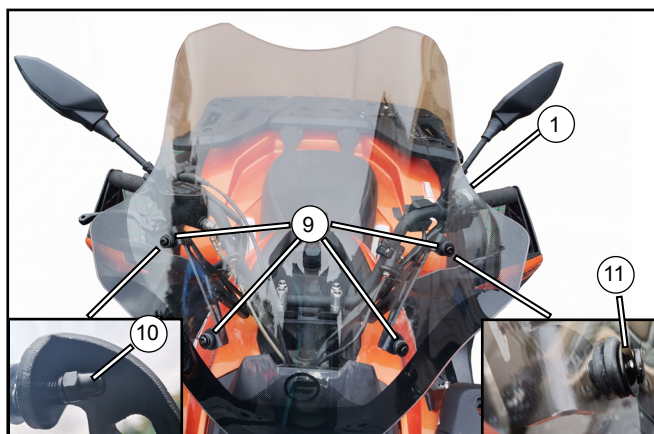

- // Fasten the windshield (1) to the brackets using the inner hex screws (9), 6x20 washers (11) and nuts (10). Torque the fasteners to specification.
- // Install the handle bar upper guard.

| | | | |
|-----------------|----------|-----------------|---------|
| INNER HEX SCREW | M6x20 | 30102-080020870 | 8-12N.m |
| WASHER | 6x20x1.5 | 30309-060870 | / |
| NUT | M8 | 30206-060570 | / |