

## ACCESSORY SETUP INSTRUCTION

### BUMPER, LIGHT GUARD -- PN 5BYV-801400-1000

VALID FOR: MY2020 and Newer ZFORCE 950 SPORT & ZFORCE 1000 SPORT

**(NOTE: Requires Front Bumper PN 5BY#-801100-1000 installed)**

**BEFORE YOU BEGIN:** Read and understand the instructions before starting any work. Make sure that all parts are ready and that you have all the tools required for assembly.

**NOTE:** CFMOTO shall not be liable for any damage caused by incorrect assembly. CFMOTO recommends that all original accessories be assembled by an authorized CFMOTO dealer.

Before assembly, park the vehicle on a flat surface, put the transmission gear into Park (P) and turn off the key switch.

**Zhejiang CFMOTO Power Co., Ltd.** All rights reserved. Reproduction of this document, even in part, as well as copying of all kinds, is permitted only with the express written permission of the copyright owner.

### MEANING OF SYMBOLS

 - Indicates information with more details or tips.

 - Indicates information of warning or danger.

### PARTS LIST:

ITEM	PART NAME	PART NUMBER	QTY.	REMARK
1	BUMPER, LIGHT GUARD	5BYV-801400-1000	1	
2	BUMPER, LH	5BYV-801410-1000	1	
3	BUMPER, RH	5BYV-801420-1000	1	
4	CLAMP 42	5BY#-801220-1000	4	
5	INNER HEX SCREW M10×30	5BY#-801100-1000-21	4	
6	RUBBER DAMPER	5BYV-801401-1000	2	
7	PLUG 38	9DS#-801200-6000-20	2	

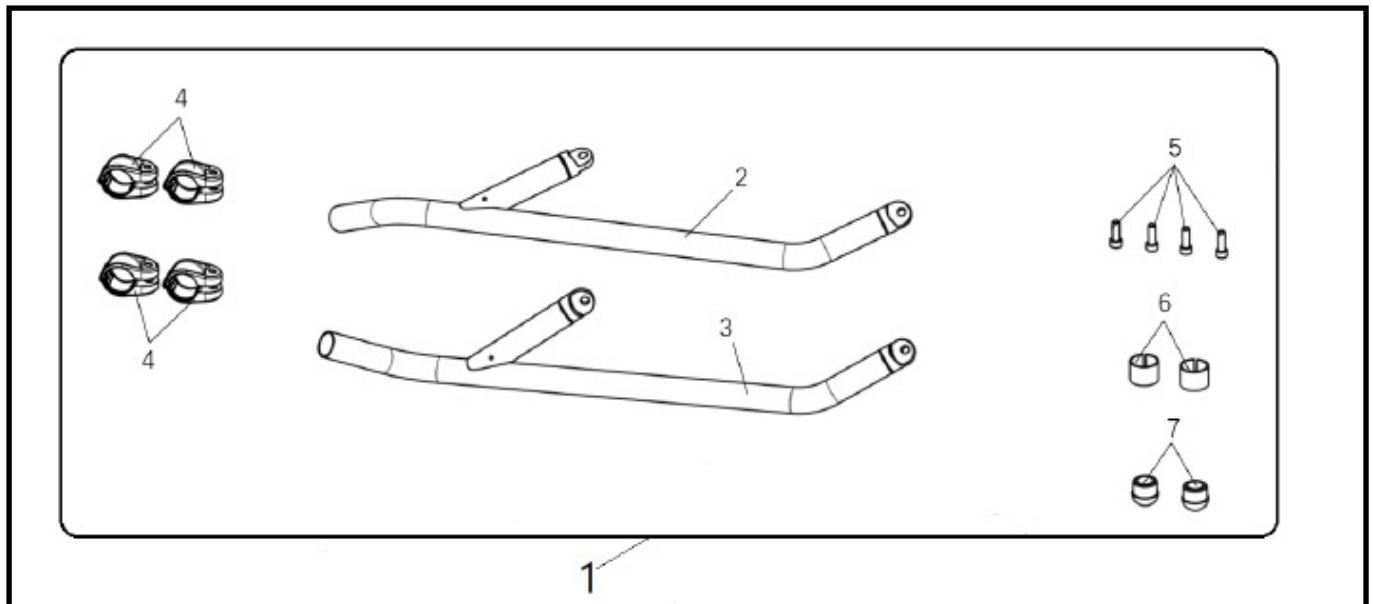

### TOOL LIST:

ITEM	DESCRIPTION	QTY.	REMARK
1	PROTECTIVE GLOVES	1	Recommended tools
2	5mm ALLEN WRENCH	1	
3	RUBBER HAMMER	1	

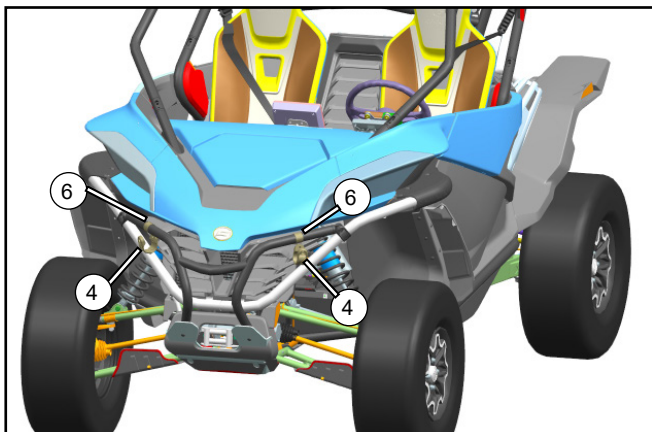
**ASSEMBLY and INSTALLATION**

// Insert a rubber damper (6) into clamp 42 (4) for each lower clamp that will mount on the front bumper.

**i** » Only the lower clamps use the rubber dampers.

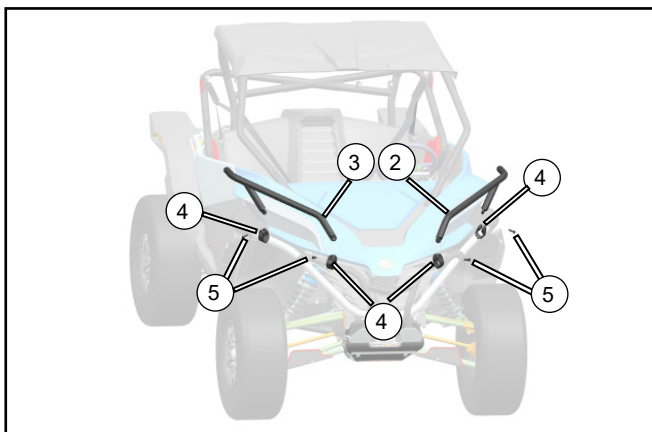

// Position the left bumper (2) and right bumper (3) on the front of the vehicle as shown to determine the clamp positions, then assemble each side with a lower clamp 42 (4-with damper), and upper clamp 42 (4-no damper). Insert inner hex screws (5) through the clamps and bumpers. Tighten the hex screws sufficiently, using care not to over-tighten.

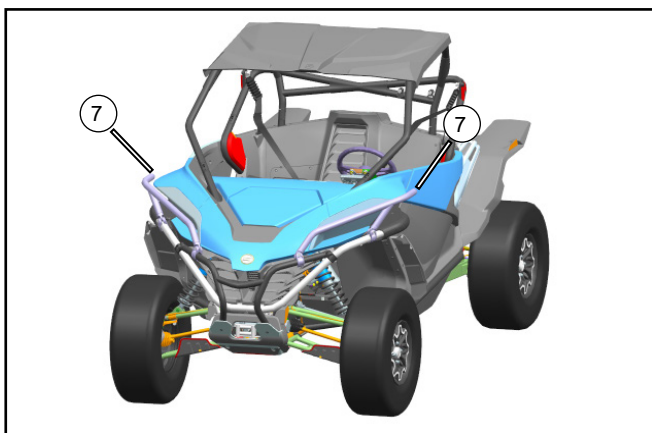

// Use a rubber hammer to install the plugs (7) into the bumper.